

June 15, 2015

Re: Revised Total Coliform Rule (RTCR) Sample Site Plan

Dear Community Water System Manager:

Since 1992, all community water systems have been operating under the Total Coliform Rule (TCR) that required monthly microbiological monitoring of your drinking water. EPA has made changes to this rule that will affect the operation of your water system. This new rule is referred to as the Revised Total Coliform Rule (RTCR). The RTCR will take effect on April 1, 2016.

There is some preliminary work that needs to be done by each water system in preparation for the RTCR. One of these areas concerns the siting of your routine, repeat, and, if applicable, your Groundwater Rule (GWR) triggered samples.

Your system at some time in the past has submitted to DENR a sample site plan that designated where you would be taking your ROUTINE TCR samples. By April 1, 2016, you must submit an updated sample site plan that designates all of your ROUTINE, REPEAT, and GWR TRIGGERED (if applicable) sampling sites.

The sampling plan must be submitted to DENR for review and approval. Your submitted sample site plan should include an actual map of your system along with a list of all your sample sites. You will then receive a letter from DENR after your plan has been approved. Failure to submit a revised sampling plan by April 1, 2016 will result in a violation that requires public notice.

More details for the sample site plan have been enclosed.

DENR will be providing training on the RTCR in August 2015, and you will be notified on the specifics of the training in the very near future; however, it would be wise to get started on your revised sample site plan.

If there are any questions on this or any other drinking water matters, feel free to contact me.

Sincerely,



Rob Kittay
Drinking Water Program
Phone: 605-773-4208
Email: rob.kittay@state.sd.us

REVISED TOTAL COLIFORM RULE (RTCR)
SAMPLE SITE PLANS

RTCR sample site plans must be submitted to the Drinking Water Program (DWP) for approval before April 1, 2016. The plan must indicate the microbiological sample locations for routine, repeat, and, if applicable, Groundwater Rule (GWR) triggered samples.

Here are definitions of each of the sample types-

Routine Samples-These are the regular monthly samples that are submitted each month from designated sites that are rotated each month.

Repeat Samples-These are the samples that are submitted immediately following a positive routine sample. These are clustered around the positive routine site.

GWR Triggered Samples-These samples apply only to systems with their own groundwater sources (wells, springs, galleries, etc). The triggered samples are taken immediately following a positive routine TCR sample. They are taken directly from each groundwater source prior to any treatment that may be present at the system.

A minimum number of sites must be used for routine sample collection during each calendar year. The number of routine sample sites for each system is as follows:

Population	Routine Samples/Month	# of Routine Sites
<1001	1	5
1001-2500	2	7
2501-3300	3	9
3301-4100	4	12
4101-6700	5-7	15
6701-21,500	8-20	20
21,501-59,000	25-60	30
>59,000	65+	40

This chart indicates the minimum number of routine sample sites necessary. You may designate more if desired. Sample sites must be representative of the water across the entire distribution system. Sample sites must be rotated on a regular basis thru out the year. Each routine site must then have two corresponding repeat sample sites as follows-

- One repeat sample site within five service connections downstream of the original unsafe routine sample site
- One repeat sample site within five service connections upstream of the original unsafe routine sample site

(Note-A third repeat sample must also be taken each time at the routine sample site where the positive sample occurred.) There may be confusion as to “downstream” and “upstream” if your water flows in different directions at certain times. Make sure you have a designated repeat site on each side of every routine site. For smaller systems, it may be possible for a repeat sample site to serve for more than one routine site.

Criteria to use when choosing all sample sites are as follows:

1. Accessible at reasonable times of the day for sampling
2. Available during entire year
3. Sites located across entire system
4. Routine site is not the last service on a dead end line
5. Site has a tap suitable for sampling. Preferably a single cold water non-swivel tap.
6. Sample sites can be at a customer's premise, dedicated sampling station, or other designated sampling locations

The sample site plans must also show the sites for GWR triggered samples. These samples apply only to systems with their own groundwater sources (wells, springs, galleries, etc).

If it is necessary to change any sampling site, a written request should be submitted to DWP indicating the reason for the change and the location of the new site to be substituted.

Systems must collect routine samples at regular time intervals thru out the month. Exception-Systems using groundwater as the sole source of their water supply and serving less than 4901 people may take all their routine monthly samples in one day provided the samples are taken at different locations.

A map of the distribution system which clearly indicates the location of each sampling site as well as all water mains, sources and reservoirs must be submitted to DWP. For your RTCR revised sample site plan, you may start with your TCR sample plan that was submitted previously to DENR and then make additions to bring it up to the new requirements.

A chart with the complete description of each sampling point including an address and the specific sampling tap at that sample site must also be submitted. (See enclosed example.)

A "sample site number" should be assigned to each site. When a sample is obtained from a particular site, the complete sample site name (such as Rob Smith House or 1111 Main Street—Not just Kitchen Tap) and number must be noted on the lab submittal form. Laboratories have been instructed to reject all samples from public water supplies that do not have a sampling site and sampling site number noted on the form.

Sample site plans must be submitted to Drinking Water Program, Foss Building, Pierre, SD 57501-3181. If there are any questions on this matter, please contact Barbara Friedeman of the Drinking Water Program in Pierre. (Phone: 605-773-4052)

Amertown SD

RTC Sample Sites

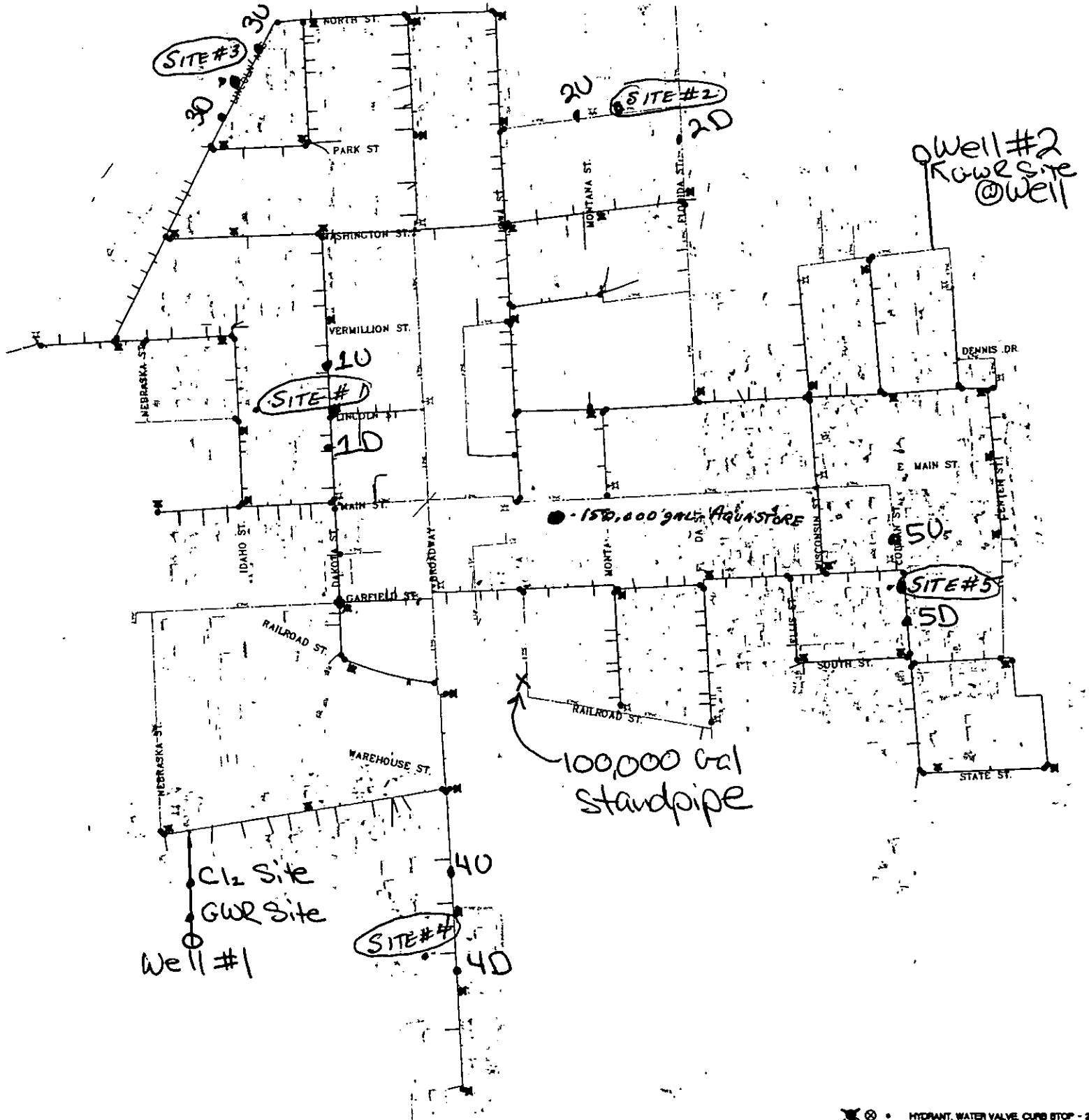

- HYDRANT, WATER VALVE, CURB STOP - 2
- 6" PVC WATERMAIN - 2004
- 8" PVC WATERMAIN - 2004
- WATERMAIN - PRIOR TO 2004
- HYDRANT, WATER VALVE, CURB STOP - P

Anytown, South Dakota RTCR Sample Site Plan March 31, 2016

Submitted by : Harvey Larsen, Utilities Manager
64 Third Street
Anytown, SD 57888-0976
Phone: 605-555-5555
Cell Phone: 605-555-5556

Routine Site #1- James Smith Home, 1040 Lincoln, Laundry Tap

Repeat Site #1U- Hanson Home, 975 Dakota, Laundry Room

Repeat Site #1D- Timmer Home, 950 Dakota, Downstairs Bathroom

Routine Site #2- Jim's Meat Market, 640 Park, Restroom

Repeat Site #2U- Hardware Store. 600 Park, Restroom

Repeat Site #2D- Johnson Home, 500 Florida, Basement

Routine Site #3- Rob Smith Home, 141 Lincoln, Bathroom Tap

Repeat Site #3U- Meyer Home, 147 Lincoln, Basement Tap

Repeat Site #3D- Olson Home, 135 Lincoln, Basement Tap

Routine Site #4- Super Value Grocery, 1121 Broadway, Women's Restroom

Repeat Site #4U- Feed 'n Seed Store, 1130 Broadway, Restroom

Repeat Site #4D- Vet Clinic, 1115 Broadway, Restroom

Routine Site #5- City Hall, 401 Garfield, Men's Room

Repeat Site #5U- Post Office, 1000 Colman, Basement Tap

Repeat Site #5D- Grocery Store, 900 Colman, Bathroom

Repeat Sites-"U" is Upstream Site and "D" is Downstream Site

GWR Triggered Sites

Well #1-GWR Sample can be taken prior to chlorinator at tap on well head

Well #2-GWR Sample taken at well-No treatment at well